



401, Point Red Midland Road, Luton, Bedfordshire, LU2 0BL
£110,000



401, Point Red Midland Road, Luton, Bedfordshire, LU2 0BL

**** Exclusive to PR Property ** Cash buyers only - block awaiting EWS1 certificate **** This newly decorated one bedroom apartment at Point Red, Midland Road, offers stylish modern living right in the heart of Luton. Located just moments from Luton Station, it's a perfect choice for singles, couples or commuters looking for convenience and comfort. Inside, the flat is finished to a high standard, with sleek contemporary fittings and a bright, open plan layout designed for practical everyday living. Ready for immediate move-in, making it ideal for those seeking a seamless start in a prime town centre location. Buy to let potential £1000pcm

ENTRANCE HALL

LIVING ROOM 19'4" X 10'6"
(5.89M X 3.20M)

BEDROOM 8'5 X 11'11" (2.57M
X 3.63M)

BATHROOM



Fourth Floor

Approx. 42.4 sq. metres (456.6 sq. feet)

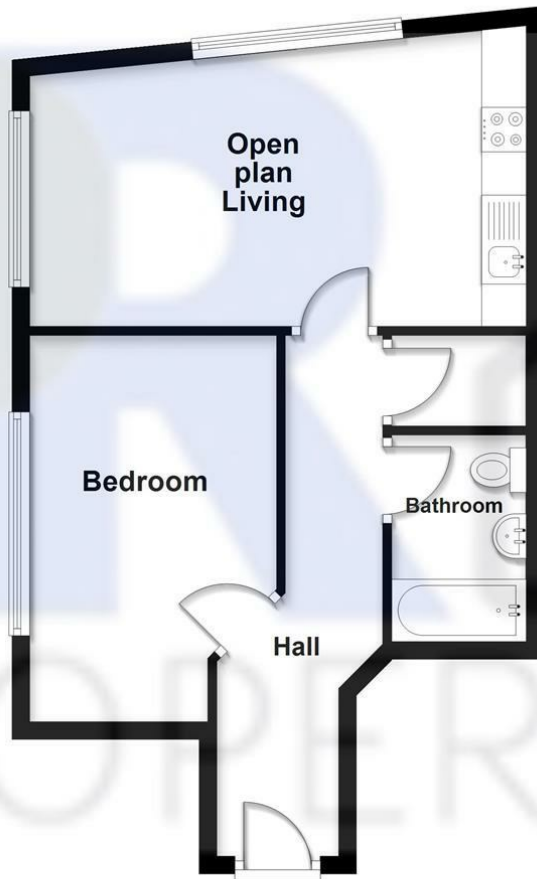

Total area: approx. 42.4 sq. metres (456.6 sq. feet)

401 Point Red, Luton

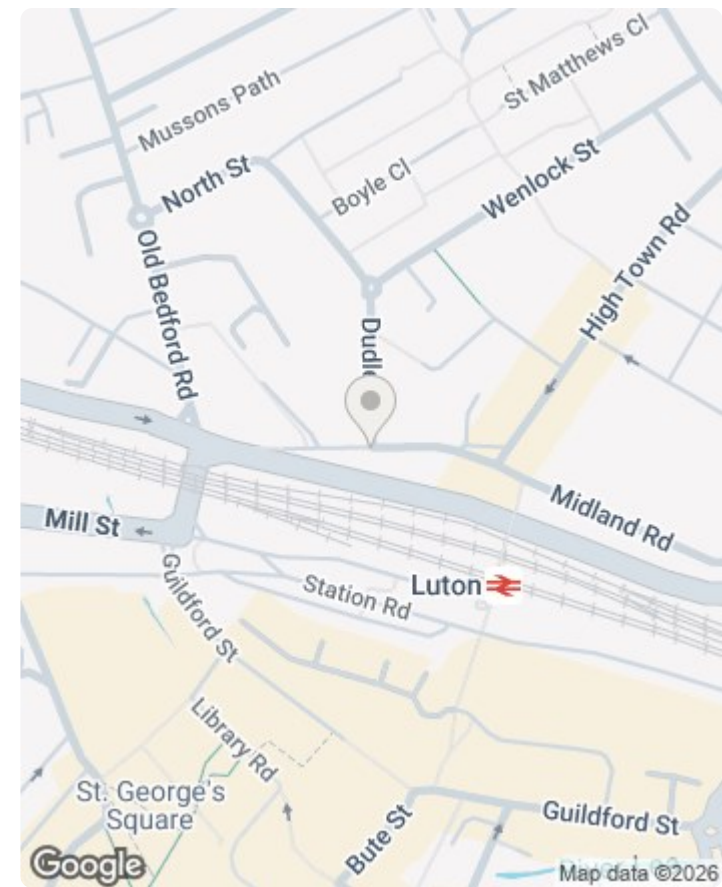

Energy Efficiency Rating		
	Current	Potential
Very energy efficient - lower running costs		
(92 plus) A		
(81-91) B		
(69-80) C		
(55-68) D		
(39-54) E		
(21-38) F		
(1-20) G		
Not energy efficient - higher running costs		
England & Wales		
EU Directive 2002/91/EC		

74

67

